

Ventilated Masonry Cavity Walls

By Pat Conway, AIA

As designers and building owners place increased demands on exterior walls to isolate the outside climate from the interior controlled environment, exterior walls' capability to provide long-term assured performance must grow. As building enclosure design evolves, it is becoming more evident that important attributes of durable exterior cavity walls, in wet climates, must include the ability of the exterior wall to drain and dry quickly to protect the wall assembly from moisture-related issues.

CAVITY WALL EVOLUTION

Historically, exterior masonry walls managed water by utilizing an abundance of mass to absorb moisture from the environment and then release it back slowly by random drainage and evaporation when the exterior relative humidity allowed. Typically, bulk water did not reach interior surfaces of thick mass walls due to the multiple masonry wythes, each with their inherent high

moisture-storage capacity. Additionally, the drying efficiency of uninsulated mass-masonry walls is aided by the passage of interior energy out through the mass (*Figure 1*).

Today, thick mass masonry walls have been replaced with thin, energy-efficient and economical masonry cavity wall construction with internal water and air barriers, continuous insulation, and air space between the structural support wall and the exterior veneer (*Figure 2*). This modern wall assembly has isolated the veneer to experience more thermal and material movement, moisture-related stresses, and staining potential than massive masonry walls. Adding to the challenge of designing durable exterior wall systems, structural masonry support walls are sometimes replaced with moisture-sensitive materials such as wood and other sheathing products

and associated framing. All these factors make rapid drainage and drying of exterior wall systems even more vital.

CAVITY WALL TYPES

Today there are three main types of cavity wall design:

- Unventilated
- Pressure-equalized
- Ventilated

UNVENTILATED CAVITY WALLS

The roots of modern cavity wall design can be traced back to the late 1800s, when wall systems started to become less massive, due to better material strength, improved

Figure 2 – Modern masonry cavity wall detail from International Masonry Institute's Masonry Detailing series, www.imiweb.org.

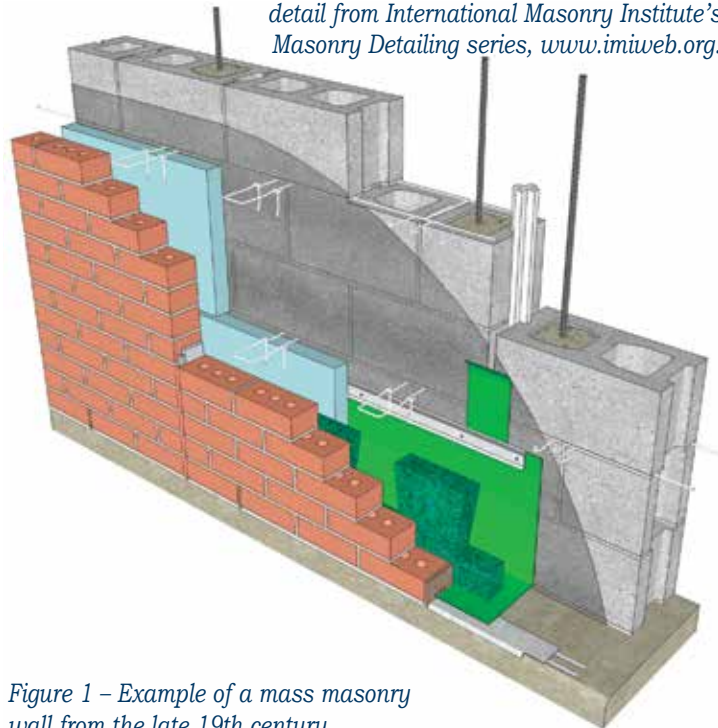

Figure 1 – Example of a mass masonry wall from the late 19th century.



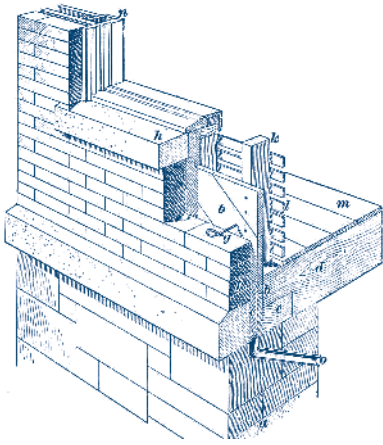

Figure 3 – Example of early cavity wall design from 1894.

As designers and building owners place increased demands on exterior walls to isolate the outside climate from the interior controlled environment, exterior walls' capability to provide long-term assured performance must grow. As building enclosure design evolves, it is becoming more evident that important attributes of durable exterior cav-

ity walls, in wet climates, must include the ability of the exterior wall to drain and dry quickly to protect the wall assembly from moisture-related issues.

CAVITY WALL EVOLUTION

Historically, exterior masonry walls managed water by utilizing an abundance of mass to absorb moisture from the environment and then release it back slowly by random drainage and evaporation when the exterior relative humidity allowed. Typically, bulk water did not reach interior surfaces of thick mass walls due to the multiple masonry wythes, each with their inherent high moisture-storage capacity. Additionally, the drying efficiency of uninsulated mass-masonry walls is aided by the passage of interior energy out through the mass (Figure 1).

Today, thick mass masonry walls have been replaced with thin, energy-efficient and economical masonry cavity wall construction with internal water and air barriers, continuous insulation, and air space between the structural support wall and the exterior veneer (Figure 2). This modern wall assembly has isolated the veneer

to experience more thermal and material movement, moisture-related stresses, and staining potential than massive masonry walls. Adding to the challenge of designing durable exterior wall systems, structural masonry support walls are sometimes replaced with moisture-sensitive materials such as wood and other sheathing products and associated framing. All these factors make rapid drainage and drying of exterior wall systems even more vital.

CAVITY WALL TYPES

Today there are three main types of cavity wall design:

- Unventilated
- Pressure-equalized
- Ventilated

UNVENTILATED CAVITY WALLS

The roots of modern cavity wall design can be traced back to the late 1800s, when wall systems started to become less massive, due to better material strength, improved understanding of the system, and a desire to reduce material cost, increase speed of construction, and minimize thermal and



Trinity|ERD is pleased to announce the opening of its new wind testing laboratory in Oxford, CT, the latest expansion of its service offering.

Having conducted static uplift testing of commercial roofing systems for over 20 years, Trinity|ERD now offers customers testing to the CAN/CSA A123.21 dynamic wind uplift resistance standard, which is the only codified wind uplift standard in the National Building Code of Canada (NBCC 2015).

- ∞ One of two ISO 17025 accredited (IAS TL-689) laboratories in the world using equipment commissioned through the National Research Council of Canada (NRC).
- ∞ 12x24 ft chamber size to mirror historical static testing.
- ∞ Criticality analysis for selection of critical components.
- ∞ ISO 17025 accredited for static wind uplift standards codified in the International Building Code and Florida Building Code.
 - ANSI/FM Standard 4474
 - UL 1897
 - Florida HVHZ TAS 114, Appendix D & J
- ∞ ISO 17025 accredited for field (in-situ) static wind uplift standards.
 - ANSI/SPRI IA-1
 - ASTM E907
 - FM Loss Prevention Data Sheet 1-52
 - Florida HVHZ TAS 124



353 Christian Street, Unit 13 Oxford, Connecticut 06478 • Phone: 203-262-9245 • lindareith@trinityerd.com

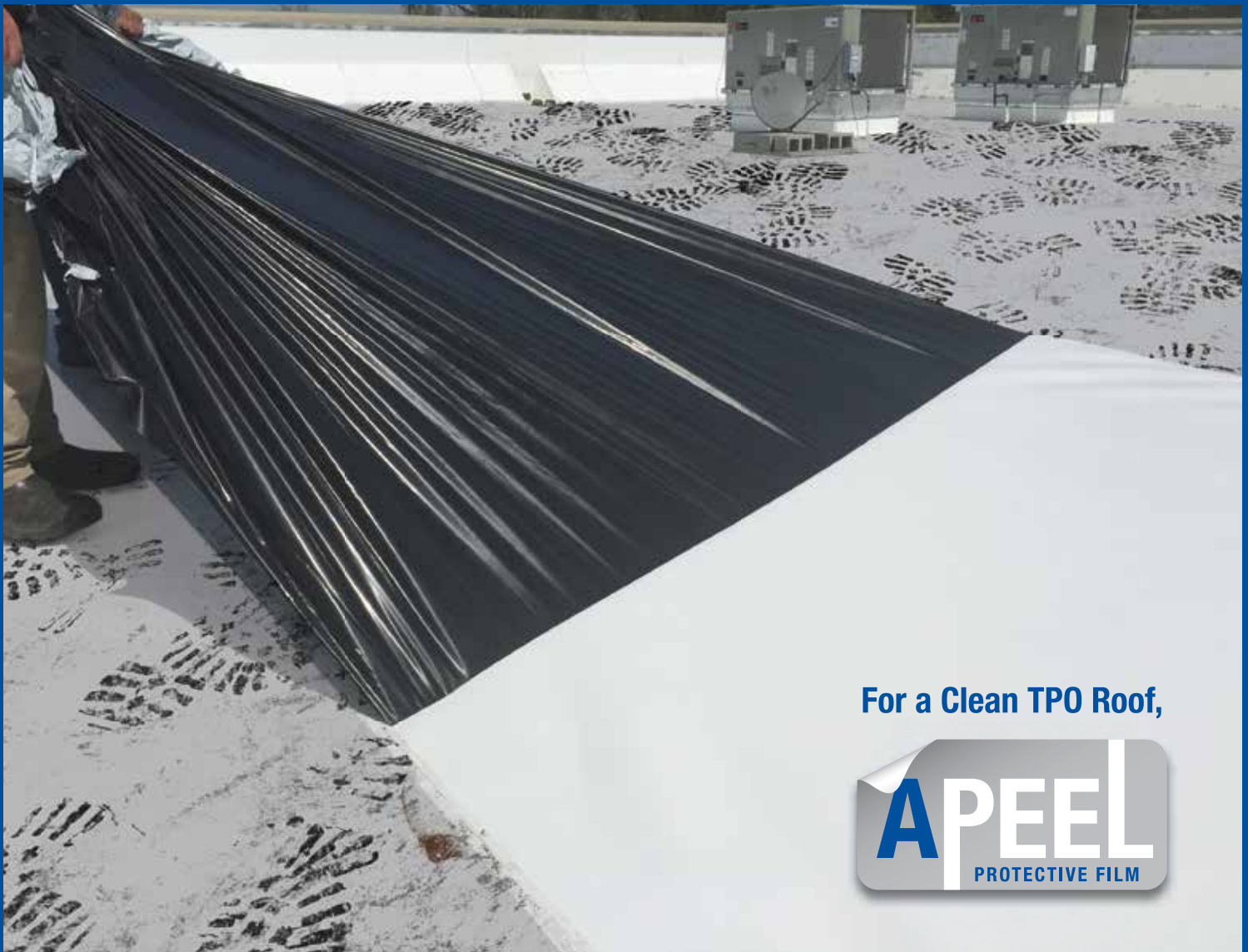

For a Clean TPO Roof,



Twice as Clean at a Fraction of the Cost

CARLISLE
SYNTEC SYSTEMS

Introducing Carlisle's Sure-Weld® TPO with APEEL™ Protective Film

- Tough protective film helps prevent scuffs and scratches on TPO membrane during the construction process
- Eliminates the need to clean or power wash the roof after installation
- Film is easily removed by one person due to its manageable 5-foot-wide size
- Film's gray color helps the surface dry quickly and cuts down on glare



For answers to frequently asked questions, scan here.

Visit us at RCI in booth #801

Experience the Carlisle Difference | 800-479-6832 | www.carlisesyntec.com

Commercial Roofing Simplified



FLEXible Solutions

- Premium Roof System Products Featuring Maximum Design Flexibility
- Pre-bid Estimating and Technical Services Project Management and Progress Inspections
- Post-Installation and Warranty Support
- Preventative Maintenance and Asset Management Programs

Visit Booth 217

For more details visit www.xtraflexroofsystems.com
or call **1-800-374-ROOF(7663)**

moisture transfer across the wall (Figure 3). For nearly 100 years, unventilated cavity walls were the norm until the mid to late 1900s, when building designers started to experiment with alternative design strategies to refine moisture, staining, and energy management methods for cavity walls by introducing upgraded wall assembly components and advanced moisture control design strategies such as pressure-equalized rainscreen wall concepts.

PRESSURE-EQUALIZED CAVITY WALLS

In theory, pressure-equalized rainscreen walls are designed to allow enough exterior air into the wall cavity to create backpressure to reduce or eliminate the positive force of wind-driven rain against the veneer. However, in reality, there are too many variables required in order for a system to be designed and installed flawlessly and achieve a true net-zero pressure differential across a veneer. To achieve a pressure-equalized rainscreen wall, the wall design needs to address:

- The rigidity of the support wall
- Actual air barrier continuity and tightness
- The weep vent type/spacing/location in the wall
- A weep-vent-free area of venting
- Increased modern air space recommendations
- Wall cavity baffle airtightness
- Mortar droppings
- Landscaping mulch
- Overall workmanship

Pressure-equalized rainscreen walls can be achieved, but not without proper calculations, design, quality control, instrumental verification, and skilled craftworkers. Because of the complexity of pressure-equalized rainscreen walls and the high level of wall assembly coordination required, it is ideal to have one contractor install the entire exterior wall assembly for single-source responsibility.

VENTILATED CAVITY WALLS

A more realistic and economical approach for increased moisture management in exterior cavity walls is the use of a ventilated cavity wall concept. Ventilating cavity walls use some similar components of pressure-equalized rainscreen walls, but without the calculations, small air space chamber requirements, observation, testing, and related cost. In fact, some building

Figure 4 – Diagram showing the two purposes of weep vents: 1) to allow moisture out of the wall, and 2) to allow air into the wall cavity. This diagram shows airflow in one direction, but it could be reversed or neutral, depending on environmental condition and building configuration. Air control is recommended on the support wall when allowing exterior air into the wall cavity.

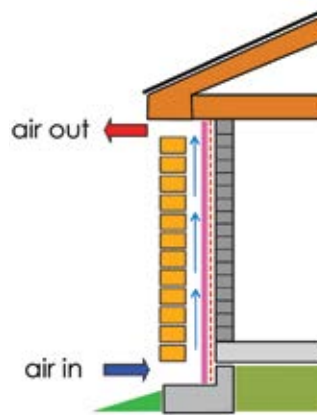

- 1) drainage
- 2) drying



Hopefully, your pipes are. Code says they must be raised up from the roof. MAPA offers an extensive line of innovative, long-lasting roof supports that add years to the life of a roof. Do it the right way. The MAPA way.

- Highest quality materials
- Allows pipes to expand and contract without abrading roof
- Quick height adjustment
- Integrated, reinforced base pads protect roof
- Ships fully assembled
- Complies with International Fuel Gas Code, MSS-58, MSS-69 and MSS-127



Innovative rooftop supports since 1998
www.mapaproducts.com

STANDARD DUTY



Single post support
 For condensate or sloped lines



Roller support
 For gas and mechanical lines

HEAVY DUTY

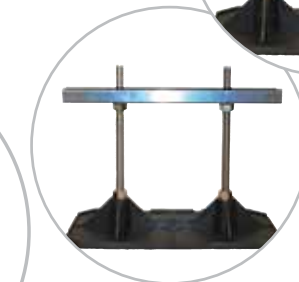
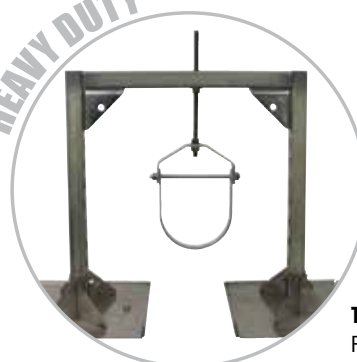

Strut support
 For conduit or refrigeration lines

Trapeze support
 For heavy duty and duct applications



Figure 5 – These inexpensive veneer connectors within an unventilated cavity wall on a spec office project that was never occupied are only six years old. Notice the premature corrosion on the veneer connectors.

scientists have stated that many, if not most, pressure-equalized rainscreen walls are not properly designed or executed and are just functioning as “well-ventilated cavity walls,” anyway.

A ventilated cavity wall works on the simple premise of letting air into and out of the wall cavity through weep vents strategically located both low and high in veneer panels to connect the internal wall cavity with the exterior environment (Figure 4). This connection promotes drying of the wall assembly as moisture is dissipated to the exterior through vents in the veneer. Venting of the wall cavity in wet climates creates walls that are more resilient with less moisture-related issues such as spalling, cracking, or staining. In some cases, the introduction of wall cavity venting to an existing unventilated cavity wall has helped alleviate or eliminate chronic efflorescence, since salt-saturated moisture does not have time to form in abundance or migrate to the surface

19 years of vegetated roof experience... brought to life in one app.



American Hydrotech introduces the Garden Roof® Planning Guide mobile app, a first-of-its-kind digital brochure that helps design professionals take a vegetated roof from initial concept to completion.

Packed with photography, technical information and videos, design professionals can explore assembly options and components, growing media and vegetation, and learn about topics such as design considerations, economic and sustainable benefits, installation and maintenance, and much more.



Download your copy today at
hydrotechusa.com/GRPG



American Hydrotech, Inc.
 303 East Ohio | Chicago, IL 60611 | 800.877.6125 | www.hydrotechusa.com

© 2015 Garden Roof is a registered trademark of American Hydrotech, Inc.

of the veneer.

At a time when wall cavities are becoming thinner and wall accessories are being “value-engineered” to fit tight budgets, increased drying capacity of wall cavities can help evaporate free or trapped moisture from within the wall assembly to keep moisture-sensitive support wall sheathing products and internal wall components such as insulation and veneer connectors at acceptable humidity levels (Figure 5). As early as 1964, *Canadian Building Digest* 50, in “Principles Applied to an Insulated Masonry Wall,” stated, “Corrosion of ties can be greatly improved by proper design that avoids serious or prolonged wetting.”

For purposes of wall assembly drying only, airflow direction and wall cavity chamber sizing do not matter. However, when letting an abundance of air into the wall cavity, air space compartmentalization should be considered to moderate pressures within the wall cavity and reduce localized high-pressure differentials across the cladding at wall panel edges and corners. Also, vertical cavity air baffles will prevent moisture-laden air within the wall cavity from traveling horizontally to possibly spread moisture-related issues throughout the exterior wall system. For example, if interior air from a highly humidified portion of the building is leaking into the wall cavity, this air could then move horizontally to express staining or corrosion in another part of an adjacent building elevation. Horizontal cavity air baffles often occur naturally at veneer shelf angles.

With ventilated cavity walls, airflow convection loops within the wall cavity will occur naturally due primarily to wind pressures, air pressure, building geometry, and stack effect phenomena. For example, when air in a wall cavity is heated by solar gain, an upward vertical flow of air may develop due to warm air rising in the wall cavity and exiting through upper weep vents. Horizontal convection loops can also develop due to the temperature of one building elevation being changed more quickly than a perpendicular elevation, such as when an eastern building elevation is warmed by the morning sun, while air within the southern, western, and northern wall cavities remains cool (Figure 6). For this reason, vertical wall cavity air baffles are a good idea at building corners. When wall cavity airflow is not controlled around corners, the influence of windward, leeward, and turbulent wind pressures could possibly create forces at the outside building corners to allow exterior

Figure 6 – This diagram shows wall cavity air baffles located at outside corners of the building and at midpoint in wall elevations. Air baffles at corners prevent wall cavity air movement around building corners. The mid-wall air baffles are only necessary when attempting to achieve a pressure-equalized rainscreen wall.

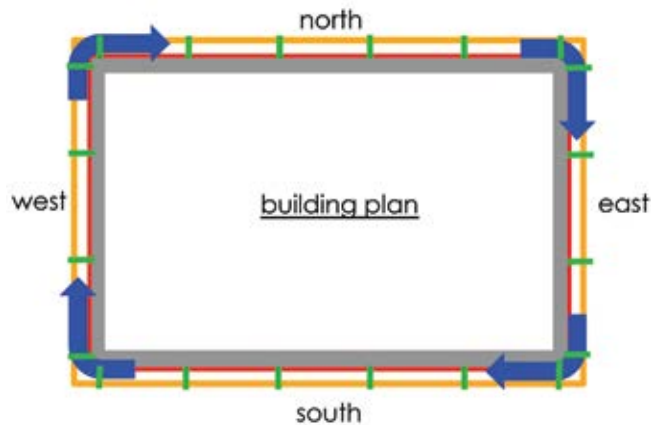

NOBODY WORKS HARDER FOR YOU.



STRONG CUSTOMER SERVICE

As a commercial roofer, you work hard. So we work just as hard for you and your customers by providing superior service such as technical support, friendly and responsive handling of orders, and job site pull tests. And with five warehouse locations across the U.S., you can get our TRUFast products right when you need them. Choose the fastening solutions team that works as hard as you do: TRUFast. Trusted Connections for commercial roofing.

TRUFast

800-443-9602 TRUFast.com

31st RCI International Convention & Trade Show | March 10–15, 2016
Rosen Shingle Creek Resort – Orlando, FL | Booth# 626

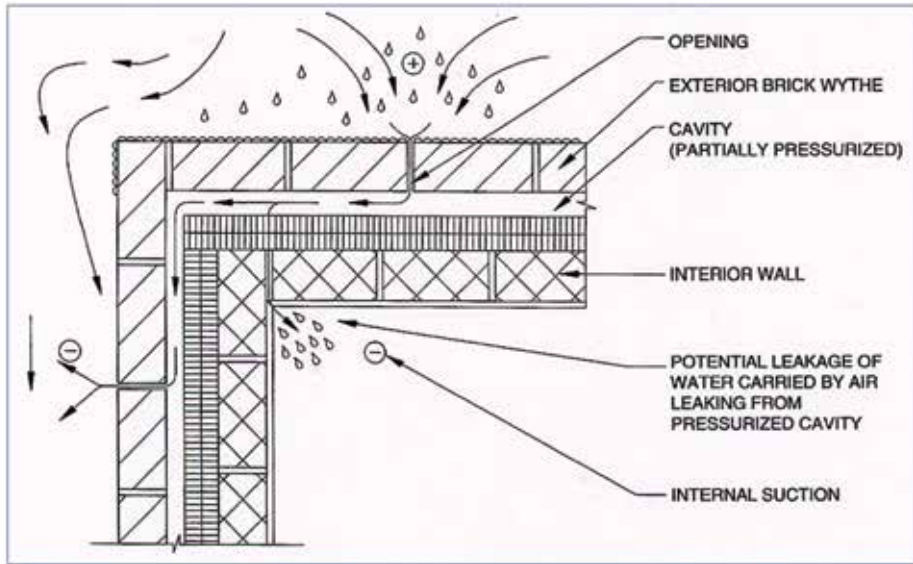

Figure 7 – Uncontrolled wall cavity airflow at exterior building corners could cause suction on veneer to draw moisture into the wall cavity. Courtesy of the Brick Industry Association (BIA).

source: Brick Industries Association (BIA)

moisture into the wall cavity (Figure 7).

The main components of ventilated cavity walls are: a vented cladding, air space behind the cladding, air barrier on the exterior side of the support wall, and through-wall flashing. If there is wall cavity insulation, then the insulation should be made continuous at joints and penetrations with tape, spray foam, or other means so air is not allowed to circulate between the insulation and the support wall, which can diminish the insulation R-value (Figure 8).

To increase drying capacity of an exterior wall assembly, it is desirable to let outside air into the wall cavity, but it is not a good idea to allow this air—with associated moisture, dust, or noise—to enter the building. This is why the use of a ventilated wall strategy should only be used when a continuous and durable air barrier is applied to the exterior side of the support wall.



Figure 8 – Wall insulation joints being foamed to make thermal control layer continuous and prevent air from circulating between insulation and support wall.

Publish in *Interface*

Interface journal is seeking submissions for the following issues. Optimum article size is 2,000 to 3,000 words, containing five to ten graphics. Articles may serve commercial interests but should not promote specific products. Articles on subjects that do not fit any given theme may be submitted at any time.

ISSUE	SUBJECT	SUBMISSION DEADLINE
July 2016	Indust. orgs. & associations	April 15, 2016
August 2016	Building failures	May 15, 2016
September 2016	Miscellaneous	June 15, 2016
October 2016	Wind	July 15, 2016
November 2016	Product manufacturing	August 15, 2016
December 2016	New mtrls. & constructions	September 15, 2016

Submit articles or questions to Executive Editor Kristen Ammerman at 800-828-1902 or kammerman@rci-online.org.

When air is allowed to enter the wall cavity for drying purposes and not pressurization, the spacing of weep vents is not critical as long as it conforms to industry recommendations, standards, and local and national codes such as the Building Code Requirements and Specification for Masonry Structures (TMS 402/ACI 530/ASCE 5 and TMS 602/ACI 530.1/ASCE 6), Section 6.1.6, which states, "Design and detail flashing and weepholes in exterior veneer wall systems to resist water penetration into the building interior. Weepholes shall be at least $\frac{3}{16}$ in. (4.8 mm) in diameter and spaced less than 33 in. (838 mm) on-center." The Canadian Building Code requirement is governed by CSA A371-04, Masonry Construction for Buildings.



Figure 9 – Polymer mesh weep vents located 8 in. on-center for more drainage and drying capacity for this veneer replacement. The original unventilated veneer showed signs of distress after only eight years. Much of the water source in the wall cavity came from condensation of uncontrolled moist interior air from this densely occupied office building in a northern climate.

Since the national model masonry code does not address ventilated cavity wall strategies, it should be noted this document still refers to small-diameter "weepholes" as opposed to larger "weep vents" that are more open to air flow. For the purposes of unventilated cavity wall design, small-diameter weepholes and rope wicks may perform to a certain degree, but for ventilated cavity wall design, full-height head joint weep vents in modular





LEADING EDGE

SAFETY

WWW.LEADINGEDGESAFETY.NET

888.990.2990

We are your solution for permanent, temporary and mobile fall protection needs. Our top priority is protecting you, your crew, and providing solutions for preventable jobsite related injuries and tragedies. With over 70 years of combined construction experience, Leading Edge Safety is creating innovative solutions with the quality you demand.



Figure 10 – Rope wicks like this polyester rope with cotton surround do not allow air into the wall cavity and are not very effective at letting water out of the wall cavity because about 80% of the rope does not have wicking properties. Furthermore, cotton rope wicks have been known to petrify when cement-laden moisture works through them.

brick veneers or partial-height inserts in larger veneer units are desirable.

When introducing intentional openings in a veneer with weep vents, common sense suggests these openings should be resis-

tant to wind-driven moisture. When using completely open head joints (without an insert) as weep vents in a masonry veneer, the bottom of the open head joints located in the upper portions of wall panels can be installed with a beveled mortar wash to resist upwardly driven rain on a saturated wall. For weep vents with an insert, the insert itself can be designed to deflect moisture.

Many weep vents on the market today are manufactured to allow ample free ventilation area while resisting wind-driven rain with materials such as entangled polymer mesh, cellular plastic, or other physical

configurations. Furthermore, openings $\frac{3}{8}$ in. (10 mm) or greater will not allow a film of water to form over them, thus negating the idea of water being blown into a weep vent. There is no known evidence that upper weep vents have caused a negative moisture problem. On the contrary, it is a common design philosophy and field observation that with ventilated cavity walls, the increased drying capacity of a ventilated cavity wall is greater



Pat Conway, AIA

Pat Conway is a registered architect in Wisconsin and a member of the American Institute of Architects. He is codirector of the International Masonry Institute's (IMI's) national masonry technical team, IMI's Director of Architectural

Education, a faculty member of IMI's Contractor College, and a provider of Craftworker upgrade courses. Conway is a frequent lecturer and author on numerous masonry subjects.

RCI

2016

Building Envelope Technology Symposium

The Westin Galleria Houston, Texas

2016 October 17-18